

Ficha Técnica

Linha Design

Tub - M133

Maçaneta: em Zamac

Broca: 55mm

Roseta: em Alumínio

Testa e Contra Testa: material usado de acordo com o acabamento



Aplicação

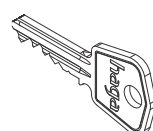

Ext.

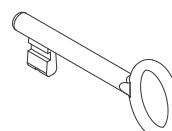

Int.

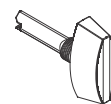

WC



Maçaneta:

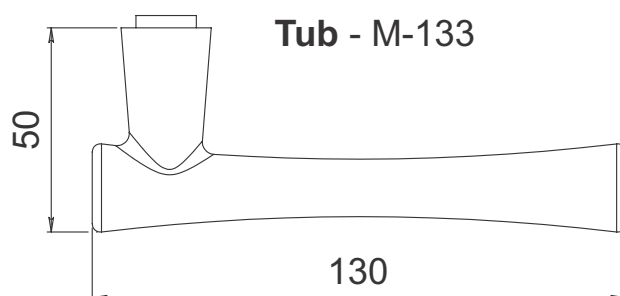
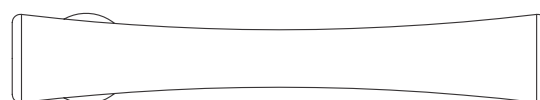

Acabamentos:



Cr
Cromado



CrA
Cromo
Acetinado

Rosetas:

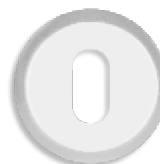

R. 370

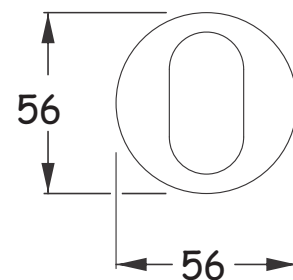

haga | 80+



mais presente - mais futuro - mais seguro

Ficha Técnica

Máquina broca de 55mm

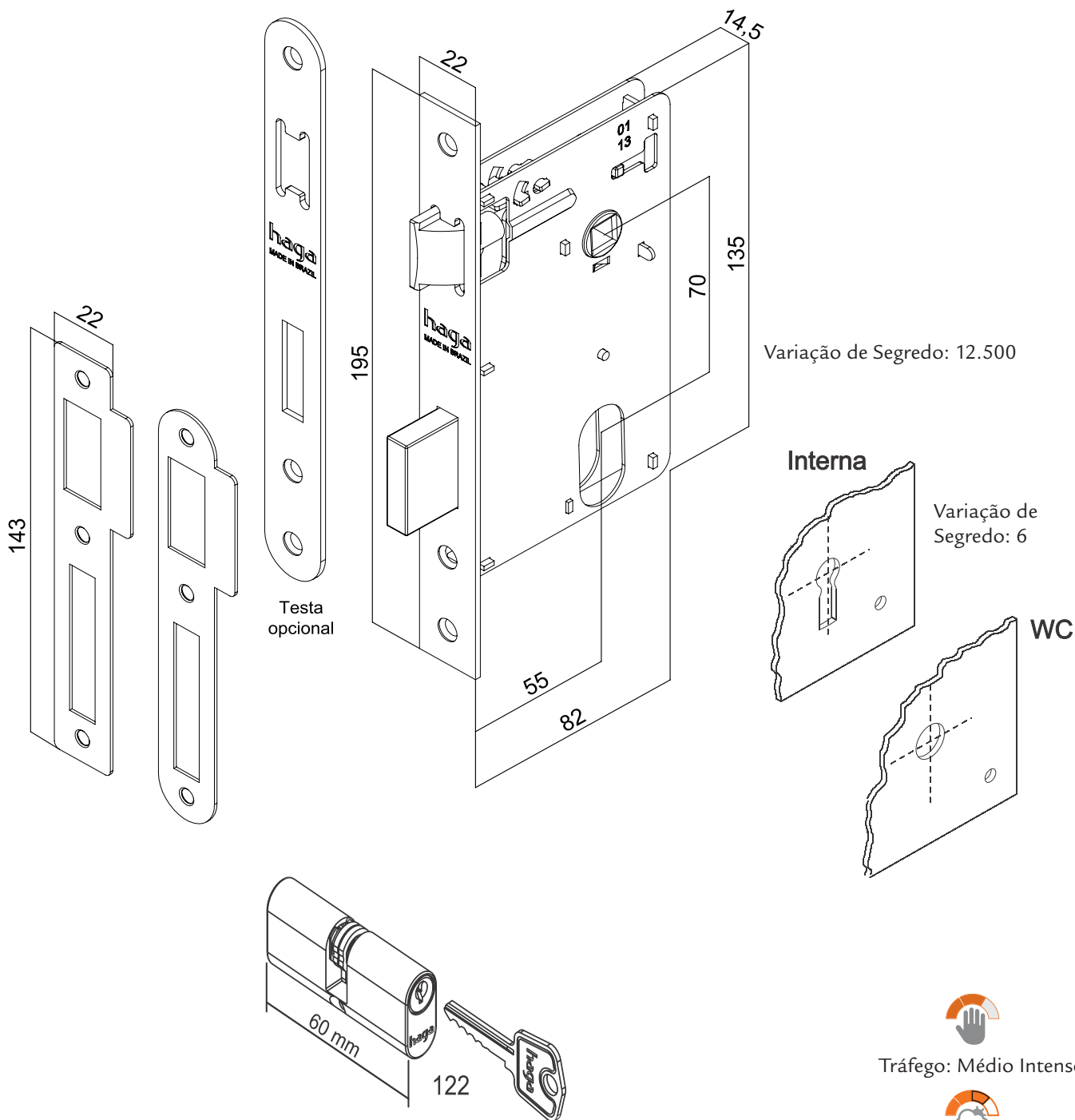

haga | 80+

Tráfego: Médio Intenso

Resistência a Corrosão:
3

Grau de Segurança:
Média Alta

mais presente - mais futuro - mais seguro